

Return Address

MACKENZIE

MACKENZIE LABORATORIES, INC.
1163 Nicole Court
Glendora, CA 91740 USA

DVCD-3000 MTS/LR

**Digital Autoload Storecaster &
Music Thru System with Local Record**

OTHER MACKENZIE PRODUCT LINES

Digital Message Repeaters - Mackenzie's line of Digital Message repeaters are the ideal audio announcement solutions for Public Address, Amusement, Entertainment, Museum and Exhibit applications. Self contained solid state systems offer unparalleled reliability. A variety of channel, connection, bandwidth and memory configurations are available.

Controls and Peripherals - Many applications require additional equipment to optimize the performance of Mackenzie products. This area focuses on items developed or sourced for their compatibility, ease of use and value. Included are, input/output controllers, speakers, amplifiers, motion sensors and pushbuttons among others.

Transit - Mackenzie is making a difference in transit applications with innovative solutions for ADA compliance and Passenger Information Systems. These products address a variety of audio and text messaging requirements and support both in-vehicle and wayside installations.

Overhead Page Management - Mackenzie's OPM series of Digital Page Stacker/Repeater and Feedback Eliminators offer advanced features for the most difficult paging and intercom applications. A unique design makes feedback virtually impossible by recording then repeating pages which opens the loop between the input microphone and speakers. Various models are available to support simple repetition, multiple page stacking and multiple input channels.



User's Manual
Version 1.1 Revised 27, July 2009
Doc 99-20-192 - \$25.00

MACKENZIE LABORATORIES, INC.
1163 Nicole Court
Glendora, CA 91740 USA

Tel: (909) 394-9007 Fax: (909) 394-9411
Email: info@macklabs.com
Web: www.macklabs.com

1. OVERVIEW

The DVCD-3000 MTS/LR is a versatile Message-On-Hold and Storecasting System, now with Local Recording capability. The MTS/LR combines high quality audio playback, background music, selectable messages, remote control and recording features for use in even the most demanding applications.

1.1 Features and Benefits:

The DVCD-3000 MTS/LR is a highly reliable audio playback system specifically designed for Message-On-Hold and Storecasting applications. The system allows music and marketing messages while clients wait on-hold or in your retail location. This heightens awareness and minimizes frustration, thus increasing sales.

Message material may be loaded into the system via a ruggedized, electronically controlled CD mechanism originally designed for automotive applications and providing years of reliable service. In addition, messages may be recorded live via the local record handset (optional) , for last minute changes or frequently updated material. Messages are digitized and stored in non-volatile FLASH memory that protects them from loss during power outage.

The DVCD-3000 MTS/LR supports up to 20 individual messages. Each message has an enable switch that allows the user to manually select which messages will be played for a particular application. The Background Music (BGM) input is for combining messages with an external music source such as CD or satellite. A built-in timer lets the user determine the time between message plays.

Multiple audio outputs (600ohm,8ohm) with level and tone control, and high quality sampling allow the sound of the DVCD-3000 MTS/LR to be optimized for almost any phone or public address system, insuring that the message gets heard.

1.2 General Specifications:

Power:

12VDC

Audio Fidelity

20kHz

80dB Signal to Noise

Handset Input:

RJ22 for local record handset(LR-HSET, supplied separately)

BGM Input:

RCA, mono, 10K ohm

Audio Outputs:

RCA, mono, 600 ohm

RCA, mono, 2.5W @ 8ohm

Manual Controls:

BGM level, BGM fade level, Tone Control, Output volume, Eject, Append/Replace, Speaker, Local Record, Music Interval, Play Mode

Switches:

Message enable/disable, Play mode, Music Interval min/sec

Package:

Painted steel chassis

2. Installation:

This section provides complete instructions for mounting the DVCD-3000 MTS/LR. Before you install the DVCD-3000 MTS/LR system, make sure you have:

-A message or music on hold input on your phone system or line level input to your public address system.

-A non-switchable 110VAC electrical outlet near the location where the unit is to be installed.

7. WARRANTY, SERVICE & RETURNS

The industrial grade housing and quality construction of the Mackenzie DVCD-3000 MTS/LR virtually eliminates the need for service or maintenance. There are no user-serviceable components within the Mackenzie DVCD-3000 MTS/LR. Refer all servicing to the factory.

7.1 Warranty Coverage:

The Mackenzie DVCD-3000 MTS/LR is tested and checked before shipment and are guaranteed against defective material or workmanship for a period of three (3) year from the date of purchase. Should trouble ever develop, contact the Factory directly by telephone or in writing. If it is determined that the equipment requires Factory service, return it to the Factory. If our inspection shows that the trouble was caused by defective material or workmanship, we will repair or replace the equipment without charge and return prepaid. Repairs made necessary by abuse, improper use, unauthorized service or maintenance, and/or improper installation, as well as out of warranty repairs, will be charged at our regular repair prices in effect at the time. The obligation under this warranty shall be limited to the replacement, repair or refund of any such defective device within the warranty period.

This warranty is in lieu of and excludes all other warranties, expressed or implied, and in no event shall MACKENZIE be responsible for damage to other equipment or property, for any anticipated profits, consequential damages, loss of item, or other operation or use of this product, and MACKENZIE'S maximum liability shall not ever be greater than the price paid for the equipment. This warranty gives you specific legal right. Your rights may vary from state to state. Inquiries regarding use, repair and service should be made to:

MACKENZIE LABORATORIES, INC.

1163 Nicole Court, Glendora, CA 91740 USA

Telephone: (909) 394-9007

FAX No: (909) 394-9411

Email: info@macklabs.com

WWW: www.macklabs.com

7.2 What we ask you to do:

To get warranty service for your DVCD-3000 MTS/LR system, you must provide proof of the date of original purchase. In the event you need to ship your DVCD-3000 MTS/LR system to the factory for service, call us for a return authorization number. When you ship your DVCD-3000 MTS/LR system, you must prepay all shipping cost. We suggest that you retain your original packing material in the event that you need to ship your DVCD-3000 MTS/LR system. When sending your DVCD-3000 MTS/LR system to the factory, include your name, address, phone number, proof of date of purchase, and a description of the operating problem. After repairing or replacing your DVCD-3000 MTS/LR system, we will ship it to your return address at no cost to you within the USA. Repair or replacement of your DVCD-3000 MTS/LR system at our factory is your exclusive remedy.

7.3 What this warranty does not cover:

This warranty does not cover defects resulting from accidents, damage while in transit to factory, alterations, unauthorized repairs, failure to follow instructions, misuse, fire, flood, and acts of God.

6. Audio CD Production Format:

The DVCD-3000 MTS/LR accepts both Red Book CDs and Data CDs.

6.1 Red Book (Audio) CD production Format:

When messages are recorded as Red Book, all messages to be placed on the unit should be recorded onto a single track with the format shown below:

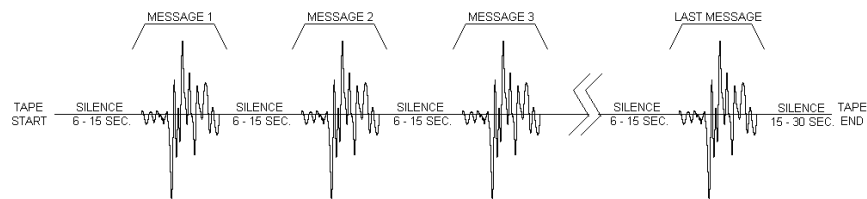

- Messages must be recorded on the left channel or track A.
- The length of individual messages do not have to be the same, but the total length of all messages should not exceed the total memory capacity of the unit.
- The silence portion between messages is not included in the max. record time.
- The audio should be set to a nominal level of -4dBm.
- The dynamic range of the production should be held low so as to allow the production to be recorded at the highest possible level without exceeding 0dBm.
- The system requires 1 second of audio at a level greater than -20dBm for the system to acknowledge the production and start recording. This is required so that the system can discriminate between noise and actual message material.

6.2 Data CD Format

The audio file placed on a data CD must be formatted as MP3, recorded at 44.1kHz sample rate, and a 32-320 kbps, or VBR bit rate. The system will not accept .WAV files on a data CD.

- All Audio files should be in the root folder of the CD
- Messages may be recorded as mono, or stereo, but unit will only play the left side audio.
- The user can choose to have a single, longer message, or multiple shorter messages on the unit.
- The length of each individual message does not have to be the same.
- The audio should be set to a nominal level of -4dBm.
- The dynamic range of the production should be held low so as to allow the production to be recorded at the highest possible level without exceeding 0dBm.
- If multiple messages are used, the files will be played in alphanumeric order by the DVCD-3000 MTS/LR. It would be beneficial to name the files in a way that the user can easily determine what they are, and the order they play. Some examples are shown below:

- 1.mpg or 1_brownies.mp3 will play first.
- 2.mpg or 2_apples.mp3 will play second.
- 3.mpg or 3_top sirloin.mp3 will play third.
- 4.mpg or 4_salmon.mp3 will play fourth.

- If more than 20 messages are detected by the system, the messages following the 20th in the ordering sequence will not be played.

2.1 Wall or Table Installation:

1. Locate a proper space on the telephone equipment board or wall. You can mount the DVCD-3000 MTS/LR unit in one of three positions: flat, side, or horizontal.
2. Position the unit on the board; mark the mounting hole locations.
3. Using the mounting screws provided, secure the DVCD-3000 MTS/LR system to the board or wall.
4. If table top mounting the DVCD-3000 MTS/LR, stick the enclosed rubber feet on the bottom of the unit.

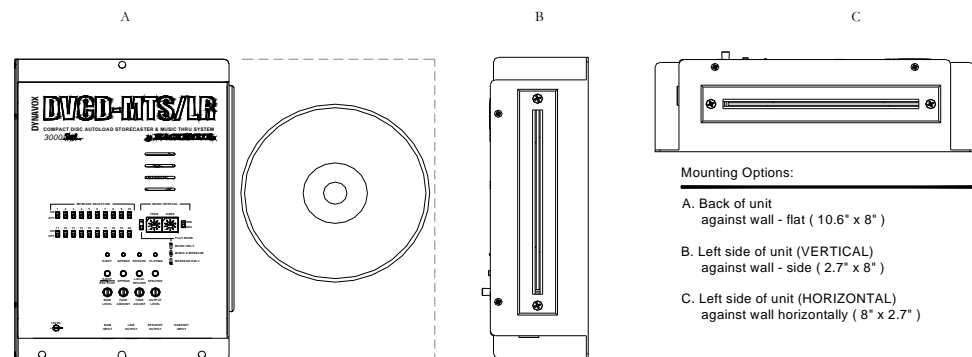

Figure 1 – Mounting

2.2 Connecting the power pack

1. Plug the power pack into a 120VAC power outlet which is not connected to a switch.
2. Plug the power plug into the DVCD-3000 MTS/LR system's power jack marked 12VDC.
3. There is no power switch on the DVCD-3000 MTS/LR system, so as soon as power is connected, the system will be active.

2.3 Connection to Telephone equipment

Connect one side of the supplied RCA cable to the telephone equipment's Message-On-Hold input. Connect the other side of this cable to the DVCD-3000 MTS/LR's LINE OUT. There are two audio outputs on the DVCD-3000 MTS/LR, LINE OUT (low level, +3dB into 600 ohms), and SPEAKER OUT (high level, 2.5W into 8 ohms). Use the LINE OUT first adjusting the audio output volume potentiometer to obtain the correct audio level. If this does not provide enough audio level, then switch to the SPEAKER OUT.

2.4 Connection to the PA equipment

Connect one side of the supplied RCA – RCA cable to the PA amplifier's line level input. Connect the other side of this cable to the DVCD-3000 MTS/LR's LINE OUT. There are two Audio outputs on the DVCD-3000 MTS/LR, LINE OUT (Low, +3dB into 600 ohms), and SPEAKER OUT (High, 2.5W into 8 ohms). Use the LINE OUT first adjusting the audio output volume potentiometer to obtain the correct audio level. If this does not provide enough audio level, then switch to the SPEAKER OUT.

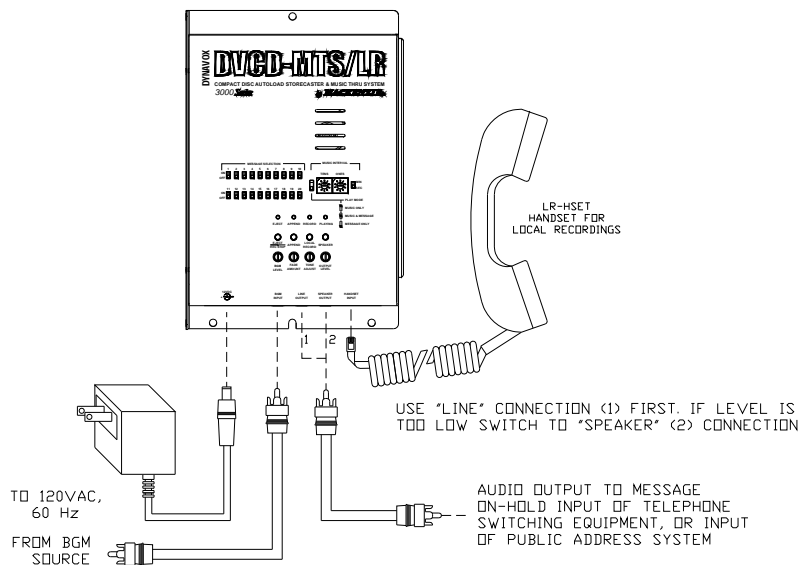

Figure 2 - Connection

3. Operation:

3.1 Message Downloading – Compact Disc:

When you receive the new DVCD-3000 MTS/LR Storecasting system, its memory will be blank. To load new messages into the DVCD-3000 MTS/LR's memory, simply insert a pre-recorded, and properly formatted (Section 6), CD into the DVCD-3000 MTS/LR unit. Make sure to insert the CD with the label side facing the top of the machine.

When a new CD is inserted, the DVCD-3000 MTS/LR will automatically start playing it. The DVCD-3000 MTS/LR will record the audio program(s), ignoring any silence segments. When the Audio program on the CD starts, the red Record light will come on signifying that Audio is being recorded. At the end of the Audio program, when the DVCD-3000 MTS/LR detects 6 seconds of silence, the Record LED will go out. The system will keep playing the CD while it "looks" for another message on the CD. If another message exists, the red Record light will go on signifying that another message is being recorded. When the last message on the CD is recorded, signified by 10 seconds of silence, the system will stop.

4. Power failure recovery

The DVCD-3000 MTS/LR uses FLASH memory which is not dependent upon power or battery backup to retain its memory. This eliminates problems associated with brown outs or unexpected power losses. When power is returned, the system will immediately start the operation it was in prior to power being removed.

5. Troubleshooting guide

Before contacting the factory, please review the following answers to some common problems.

No LEDs are active on the DVCD-3000 MTS/LR.

- When a CD is inserted, all LEDs will be off before audio is detected.
- Verify that the power adapter is plugged into non-switched AC power outlet.
- Verify that the power connector is plugged completely into the jack on the DVCD-3000 MTS/LR.

The system will not mechanically load the CD into the system

- Push the CD completely into the DVCD-3000 MTS/LR.
- Verify that the power adapter is plugged into non-switched AC power outlet.
- Verify that the power connector is plugged completely into the jack on the DVCD-3000 MTS/LR.

The system ejects the CD immediately after it is loaded.

- If in Append & Replace mode and the memory is full.
- If in Append & Replace mode and all of the messages are used.
- If it is an endless loop CD.

The Record LED never comes on after the CD is loaded into the system

- Verify that the CD was inserted right side up.
- If the CD is blank, the Record LED will never come on.
- Verify that the nominal level of the Audio recorded on the CD is over -20dB.

After recording the CD, the CD ejected, and the system is not playing a message.

- Pressing, and holding the edit/eject button while recording will eject the CD immediately.
- Verify that the CD was inserted right side up.
- If there is no audio on the CD, it will eject automatically when it reaches the end of the CD.

Can't hear anything from the audio output

- If Record and MOH LEDs are off, there is no audio being output by the system.
- Verify that the RCA to RCA connector is securely attached to the DVCD-3000 MTS/LR and the phone system.
- Turn the output level adjustment clockwise to increase the Audio output level.
- Use the 8 ohm output instead of the line level output.

Can't hear anything through the monitor speaker

- If both Record and MOH are off, there are no recorded messages on the system.
- Press the Speaker button so that it locks in the depressed position.

The system didn't record all the messages on the CD

- If there is noise in the silence portions separating the messages on the CD, multiple messages can get grouped into a single message location on the unit.
- If in Append/Replace mode, the CD has more messages on it than there are locations enabled or available on the system.

3.7 Slide Switch descriptions

Several slide switches are provided on the top cover of the DVCD-3000 MTS/LR. These switches control the functions described below:

Message Selection Switches

The DVCD-3000 MTS/LR system can play up to 20 messages. Each message has a message selection switch associated with it. These switches allow the user to enable or disable messages to be played, or recorded. The system will recognize changes of the message selection switches during normal operation.

When a message selection is in the "ON" position, the message is enabled. When the DVCD-3000 MTS/LR is in play mode, it looks at the switch for all recorded messages. If the message is enabled, the system will play the message. When a message selection switch is in the "OFF" position, the message is disabled. If the switch is disabled, the system will skip the message.

3.8 Connections

12VDC, 2.5mm Barrel connector

The system is powered by a 12VDC @ 1 Amp power adapter. Use only the AC-DC power adapter supplied by the manufacturer to guarantee proper operation.

LINE OUTPUT, RCA connector

A 600 ohm, audio output. When installing the DVCD-3000 MTS/LR system, connect this output to the phone system, or PA system, first.

SPEAKER OUT, RCA connector

An amplified, 2.5 watt into 8 ohm, audio output. Use this Audio output if the on-hold circuit, or PA system, requires a higher level than the line output can drive.

BGM INPUT, RCA connector

A 10K ohm audio input. When installing the DVCD-3000 MTS/LR system, connect this input to the output of the background music source.

HANDSET INPUT, RJ22 connector

Local record input for connecting an optional handset (LR-HSET).

The DVCD-3000 MTS/LR system offers two Message Download Modes; Replace All and Replace and Append. See below for details.

3.1.1 Message Download Mode 1 - Replace All (Replace/Append LED: OFF)

When this mode is used, the system will erase all the messages in memory as soon as the CD is inserted. The system will begin recording the messages from the CD into memory starting from message #1 and continuing through the last message on the CD. Use this mode any time all of the messages on the DVCD-3000 MTS/LR system need to be updated.

Important: Once a CD is inserted into the DVCD-3000 MTS/LR system, in this mode, all of the messages in memory will be deleted immediately. Even if the CD is then ejected prior to recording any audio, the DVCD-3000 MTS/LR's memory will be empty.

3.1.2. Message Download Mode 2: Replace and Append (Replace/Append LED: ON)

This mode allows the user to add or replace any number of messages on the system. Activate this mode by pressing the Replace/Append button until the Replace/Append LED lights. Turn ON the message selection switches of the messages to be overwritten. Make sure to turn OFF the message selection switches of the messages you want saved. Insert the CD with the new messages on it and the system will rewind the cassette and start playing it. The first message on the CD will overwrite the first active message, signified by its message selection switch being ON. The second message will replace the second active message, and so on.

If there are more messages on the CD than there are messages set up to be overwritten, the DVCD-3000 MTS/LR will append the extra messages until there are twenty messages recorded on the system, or until the last message on the CD is reached.

Example: The DVCD-3000 MTS/LR system has ten messages currently recorded on the system. To replace message 3 and 7 with new messages and add three more messages to the system follow the steps below:

1. Activate the Append mode.
2. Enable message selection switches 3 and 7.
3. Disable all other message selection switches.
4. Insert the CD which has the five new messages on it.
5. The system will transfer the first message on the CD into message 3.
6. The system will transfer the second message on the CD into message 7.
7. The system will then transfer the last three messages of the CD into locations 11, 12, and 13 on the DVCD-3000 MTS/LR, respectively.

It is not necessary to enable a message location to Append messages to memory. If the user wants to simply append messages to the system, activate the Replace/Append mode and disable all of the message selection switches. Insert the CD with the new messages and it will transfer the messages from the CD into any empty message locations on the unit.

The Audio being recorded will be output through the 8 ohm and line outputs during the recording process. This audio may also be monitored locally by depressing the "Speaker" button.

3.2 Message Downloading - Local Record Handset:

You may also create messages for the DVCD-3000 MTS/LR by recording them directly to the unit using the optional LR-HSET handset. This feature allows you to make a custom recording to any of the 20 message locations on the unit. These messages may be updated at any time for maximum flexibility.

1. Plug the LR-HSET(sold separately) into the Local Record Input.
2. Press the Local Record pushbutton to initiate the record sequence, Record LED (RED) will blink.
3. Toggle the desired message location switch two (2) times to begin recording.*
4. The Record LED should now be illuminated, record your message into the handset.
5. Press the Stop button to stop recording.
6. A preview of the message will automatically be played after the recording has been stopped.

*NOTE: Local recordings may be made to message locations that are either enabled or disabled. If disabled, toggle the switch up then down to begin recording. If the message location is enabled, toggle the switch down then up to begin recording. Always leave the switch up, or enabled, if you want it to playback.

3.3 Automatic message playback

After messages have been placed in memory, the DVCD-3000 MTS/LR will automatically begin playing them through the audio outputs. There is no control, or user input, required to initiate the playback. The green, Playing LED will light whenever the system is playing messages.

All enabled messages will be played back sequentially, as described in Section 6, with a user programmed delay time inserted between them (see section 3.7 for delay configuration information). If an enable switch is active, but has no associated message recorded into that position, the position will be skipped.

When the DVCD-3000 MTS/LR is in record mode with Append/Replace mode active, the system will overwrite any messages whose message selection switch is enabled, while protecting the messages whose message selection switch is disabled. All message selection switches are ignored when the system is recording and the Append/Replace mode is not active.

Play Mode

The DVCD-3000 MTS/LR system has three play modes, Music Only, Message Only, and Music and Message. A three position slide switch sets the mode of the system.

Music Only – No pre-recorded messages are played when the system is in this mode. The system will simply route the BGM audio directly to the output.

Message Only – Pre-recorded messages will be played sequentially based on the Music Interval setting. The BGM audio will be muted, however. No audio will be present on the audio output connector between pre-recorded message plays.

Music and Message (Default) – This mode allows Pre-recorded messages to be played sequentially based on the Music Interval setting. When a message is playing, the BGM audio will be mixed in with the pre-recorded audio. Between pre-recorded message plays, the BGM Audio will be routed directly to the audio output.

3.6 Audio adjustments

There are four potentiometers on the DVCD-3000 MTS/LR system allowing the user to tailor the BGM level, the audio output level and frequency response of the unit. Refer to the Quikey for location of each control.

Output Level

This controls the level of both audio outputs on the DVCD-3000 MTS/LR. When turned clockwise, the system will increase the audio output level through both the Speaker Output and the Line Output. When turned counter-clockwise the system will decrease the audio level through these outputs.

Note: This potentiometer does not affect the level of the monitor speaker.

Tone Adjustment

Adjusts the tone of the output audio through both the Speaker Output and the Line Output. When turned clockwise, the system will lower the bass, while adding treble to the audio output. When turned counter-clockwise the system will lower the treble, and add bass to the audio output. When in the center position, no Treble, or Bass is added to the system.

Use this adjustment to tailor the audio response for the telephone system or PA system.

Note: This potentiometer does not affect the level of the monitor speaker.

BGM Level

This sets the overall level of the background music being fed into the DVCD-3000 MTS/LR. Turning this potentiometer counter clockwise will lower the BGM level. Turning this potentiometer clockwise will raise the BGM level.

Typically, if the BGM audio seems distorted, the BGM input level is too high, and this potentiometer should be adjusted counter-clockwise to resolve the problem.

(BGM) Fade Amount

This potentiometer allows the user to set the amount of fade to be applied to the BGM audio when a pre-recorded message is played by the system. Adjusting this potentiometer clockwise increases the fade amount, meaning the BGM level is lowered more when a pre-recorded message is played. Adjusting this potentiometer counter clockwise decreases the fade amount, meaning that the BGM level is not lowered as much when a pre-recorded message is played.

When this potentiometer is adjusted fully counter-clockwise, there will be no fade to the BGM when a message is played.

When this potentiometer is adjusted fully clockwise, the system will fade the BGM by approximately 30dB when a message is played.

3.5 LED (Light Emitting Diodes) descriptions

Eject LED, Yellow

This LED will light whenever the CD is ejected, i.e. no CD in the system. When a CD is inserted, and loaded, i.e. CD is completely inside the machine, this LED will go out.

Record LED, Red

This LED will light when the DVCD-3000 MTS/LR starts recording an Audio program, and will go out when the recording process stops. This LED also blinks while the system is in local record setup mode.

The Record LED will blink one time when the DVCD-3000 MTS/LR is powered on, indicating that the memory operational.

Append, Red

This LED indicates the message download mode. When this LED is OFF, the system is in Replace All mode. When this LED is ON, the system is in Replace and Append mode. This setting is not saved when power is removed, and reapplied to the unit. Operation of the unit in Replace/Append mode is described in the Message Download (Section 3.1.2).

MOH LED, Green

This LED will light whenever the DVCD-3000 MTS/LR is in automatic playback mode and playing messages, or outputting the BGM audio.

Music Interval

Two Rotary switches and a slide switch make up the Music Interval setting. The two rotary switches allow for a setting from 00 to 99. The left rotary switch represents the “tens” position, while the right rotary switch represents the “ones” position.

The slide switch to the right of the rotary switches sets whether the 00 to 99 setting is in minutes or seconds.

For example: If the Left rotary switch is set to 2, and the Right rotary switch is set for 5, and the slide switch is set for SEC, the DVCD-3000 MTS/LR is set to delay 25 seconds between message plays.

These switches are read by the system during operation, so changing the setting can be performed while the unit is playing messages.

3.4 Pushbutton descriptions

Eject / Rec Stop pushbutton – Red, momentary

Allows the user to stop the recording process, in several ways, and/or eject the CD.

- When the system is not recording, the button functions as an Eject button.
- When the DVCD-3000 MTS/LR is recording audio, (whenever the Record LED is on) pressing this button momentarily will stop the recording and save the Audio which was just recorded. The system will rewind the CD, but not eject it.
- If this button is pressed and held for two seconds while the DVCD-3000 MTS/LR is recording, the message just recorded will be deleted, and the CD will be ejected without being rewound.
- If the button is pressed momentarily while the DVCD-3000 MTS/LR is recording audio, and then pressed momentarily again, the system will stop the recording process, save the Audio just recorded, and eject the CD.

Append / Replace pushbutton – Black, momentary

Pressing this button toggles the Replace/Append mode. The status of the Append and Replace mode is signified by the Replace/Append LED. When this LED is on, the system is in Replace/Append mode. This setting is not saved when power is removed, and reapplied to the unit.

Operation of the unit in Replace/Append mode is described in the Message Download section(3.1).

Local Record pushbutton – Red, momentary

Pressing this initiates local recording. See section 3.2 for details on the Local Record operation.

Speaker pushbutton – Black, locking

A monitor speaker, on the front side of the unit, allows the local user to hear the Audio being output by the DVCD-3000 MTS/LR. Pressing this button momentarily toggle the setting of the monitor speaker.

The volume of the monitor speaker is preset, and is not adjustable in the field.

Note: Do not adjust the Audio output level adjustment in order to hear the monitor speaker level better. Doing this will adjust the level of the Audio output which may not be acceptable.

**Model DVCD-3000 MTS/LR
STORECASTER & MESSAGE-ON-HOLD
SYSTEM WITH LOCAL RECORD**

- 1 MESSAGE SELECTION 1-20:**
Enable and disable messages to be played or recorded. Off (down) On (up).
- 2 APPEND MODE LED (YELLOW):**
Indicates if system is in Standard mode (OFF) or Replace & Append mode (ON).
- 3 EJECT LED:**
Yellow light ON indicates there is no CD inserted. Yellow light OFF indicates the CD is in place.
- 4 LOCAL RECORD PUSHBUTTON:**
Press this button to initiate local record function.
- 5 APPEND PUSHBUTTON:**
Toggles the Append mode as displayed on the associated LED.
- 6 EJECT / RECORD STOP PUSH-BUTTON:**
This ejects the CD when the system is playing downloaded messages. If pressed during the recording process the recording will be stopped.
- 7 BGM LEVELS KNOB:**
Adjusts level of external music source.
- 8 FADE AMOUNT KNOB:**
Adjusts amount the BGM input is ducked when a message is played.

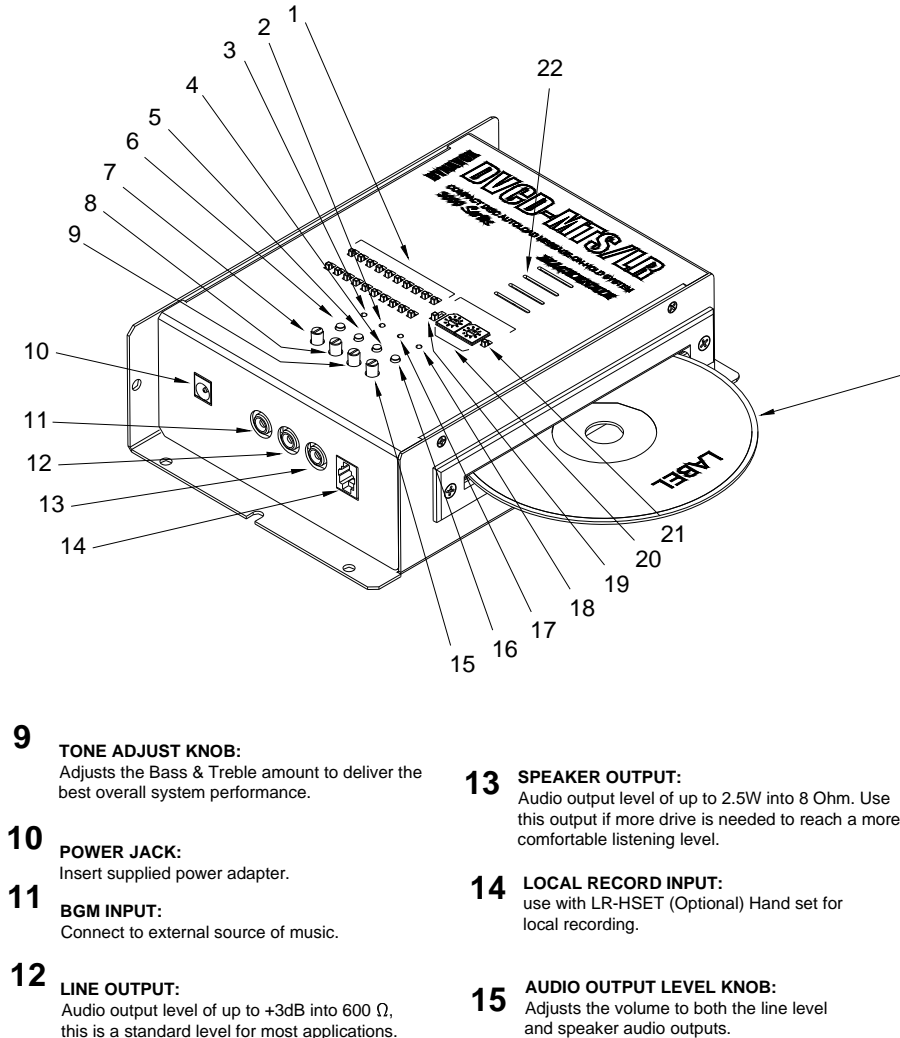

**THE MACKENZIE DYNAVOX
DVCD-3000 MTS/LR Quikey**

27 JUL 2009, Version 1.1
Mackenzie Laboratories, Inc.
1163 Nicole CT, Glendora, CA 91740 USA
TEL (909) 394-9007 FAX (909)394-9411
www.macklabs.com

- 9 TONE ADJUST KNOB:**
Adjusts the Bass & Treble amount to deliver the best overall system performance.
- 10 POWER JACK:**
Insert supplied power adapter.
- 11 BGM INPUT:**
Connect to external source of music.
- 12 LINE OUTPUT:**
Audio output level of up to +3dB into 600 Ω, this is a standard level for most applications.
- 13 SPEAKER OUTPUT:**
Audio output level of up to 2.5W into 8 Ohm. Use this output if more drive is needed to reach a more comfortable listening level.
- 14 LOCAL RECORD INPUT:**
use with LR-HSET (Optional) Hand set for local recording.
- 15 AUDIO OUTPUT LEVEL KNOB:**
Adjusts the volume to both the line level and speaker audio outputs.

COPYRIGHT POLICY

Recording, downloading or playing of copyrighted material such as sound effects, narration or music is unlawful unless permitted by a legal exception or consented to by the rights owner. Recording and download equipment should only be used with material that you have the legal right to copy and you are responsible for obtaining these rights, Mackenzie Laboratories, Inc. has no right to grant such permission.

NOTE:
Insert Pre-Recorded CD as shown (CD label facing up), system will then start loading (Red LED is on) at the end of downloading the message (s), the Red LED will turn off, system will automatically start playing the enabled message (s) from digital audio memory.

- 16 SPEAKER PUSHBUTTON:**
Turns local Monitor speaker ON/OFF.
- 17 RECORD LED:**
Used to display recording mode. Red light ON, indicates message (s) is being loaded into memory from CD or from Handset.
- 18 PLAYING LED (GREEN):**
This green LED is ON when the system is playing Pre-Recorded messages.
- 19 PLAY MODE SWITCH:**
UP = music only. (Only BGM heard)
MID = music & message. (Normal operation)
DOWN = message only. (BGM muted)
- 20 MUSIC INTERVAL-Tens and Ones Rotary Switches:**
Set music interval between message plays. Set the rotary switches to the desired time between 00 and 99.
- 21 MUSIC INTERVAL-Minute/Second Switch:**
Programs rotary switch setting for minutes or seconds.
- 22 MONITOR SPEAKER:**
Allows user to preview message play back.